

A TYPICAL FLOOR/CEILING CONSTRUCTION W/ CARPET FLOOR FINISH
1 HR FIRE RATED - UL DES. L570 - STC =50, IIC = 60

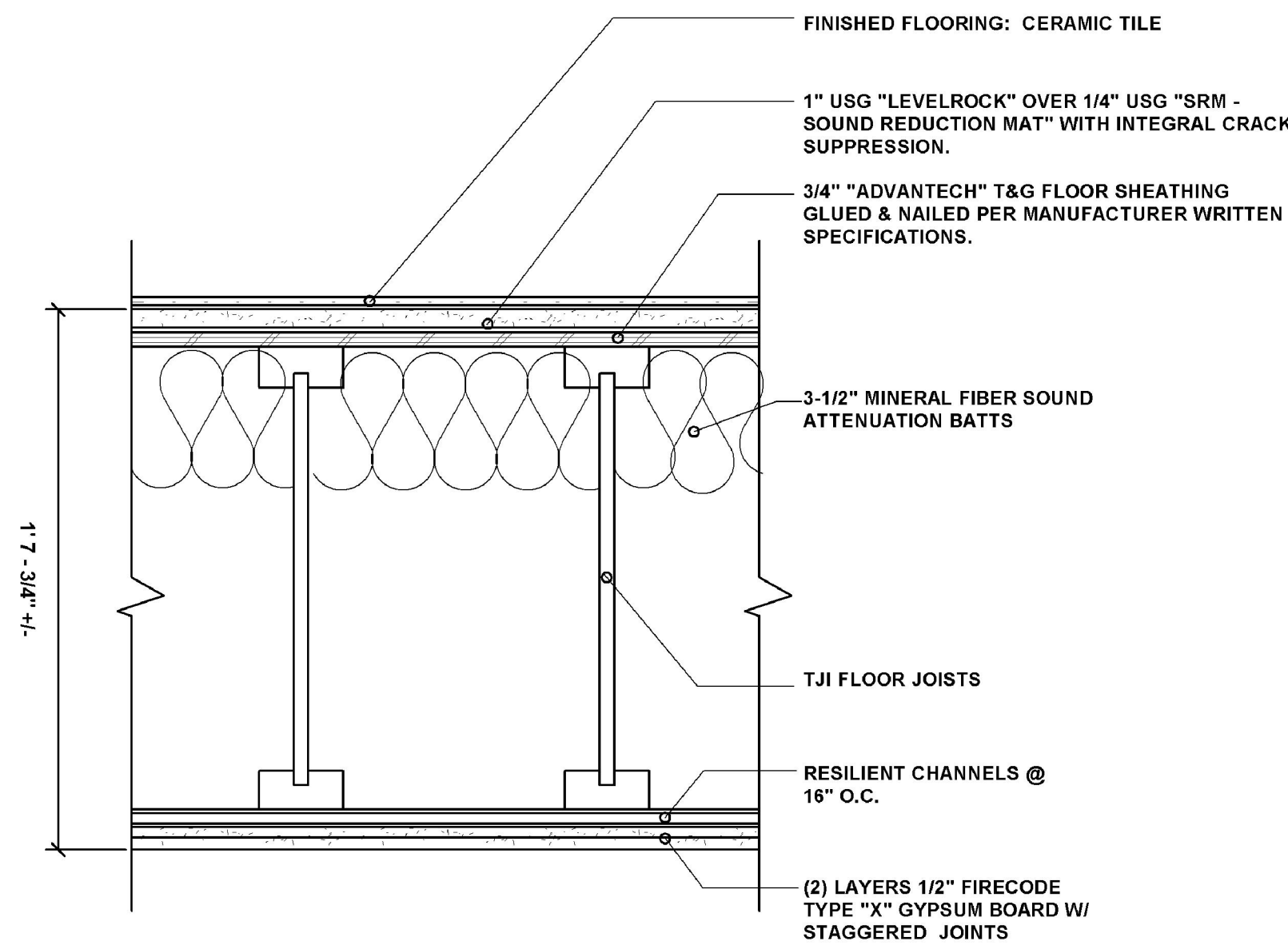

B TYPICAL FLOOR/CEILING CONSTRUCTION W/ CERAMIC TILE FLOOR FINISH
1 HR FIRE RATED - UL DES. L570 - STC =66, IIC = 54

WALL TYPE NOTES:

1. PROVIDE MOISTURE RESISTANT GYPSUM BOARD AND SOUND ATTENUATING BATTS AT ALL BATHROOM WALLS.
2. USE U.L. APPROVED FIRE STOP AT ALL FLOOR PENETRATIONS WHERE REQUIRED.
3. PROVIDE ACOUSTIC SEALANT AT ALL MECH., PLUMBING, AND ELECTRICAL PENETRATIONS.
4. ALL INTERIOR PARTITION WALLS ARE TYPE 3 UNLESS NOTED OTHERWISE
5. REFER TO STRUCTURAL DWGS FOR ADDITIONAL REQUIREMENTS
6. ALL EXTERIOR WALLS TO BE 2X6 @ 16" O.C.

FLOOR TYPES

SCALE: NTS

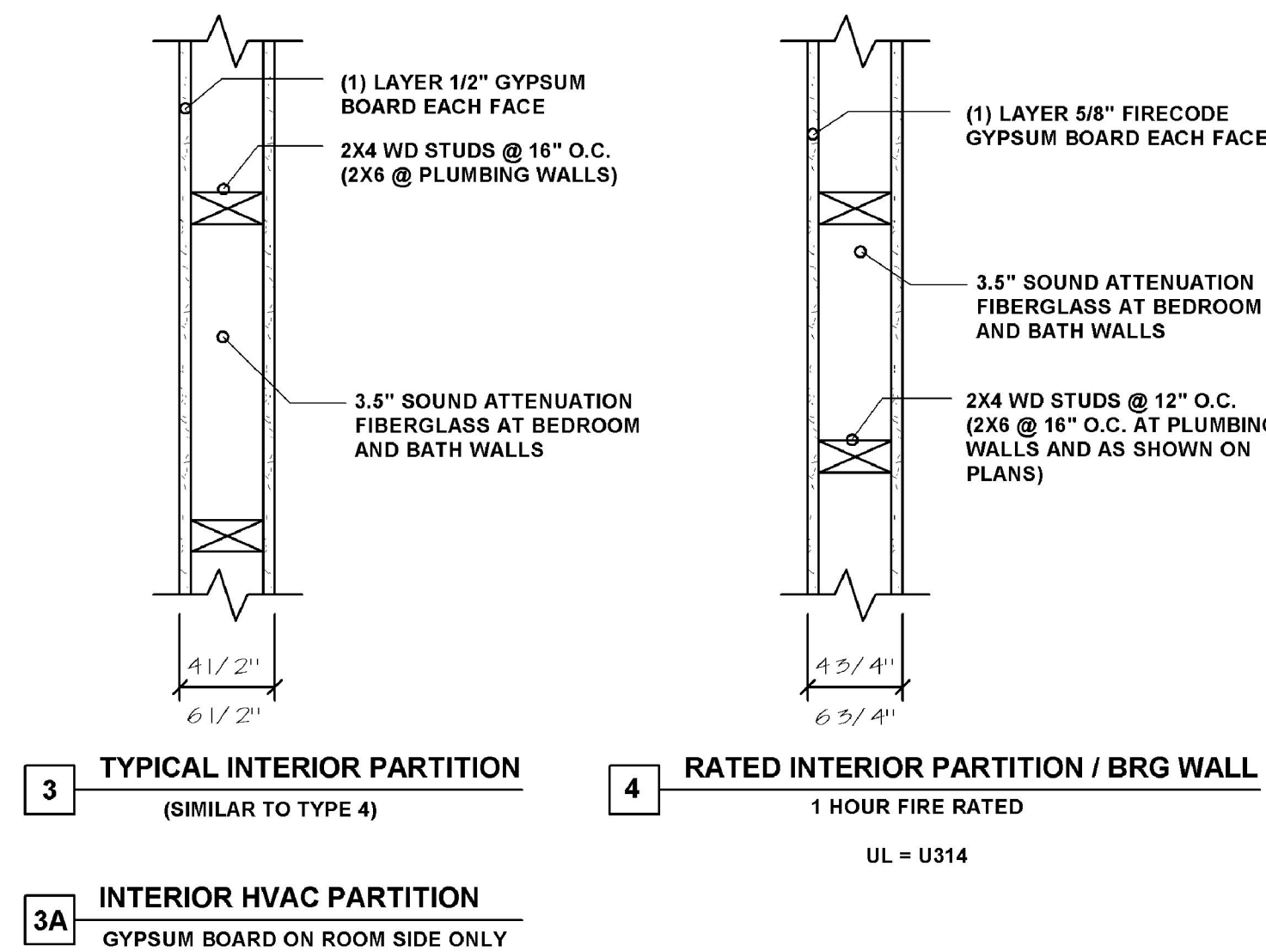
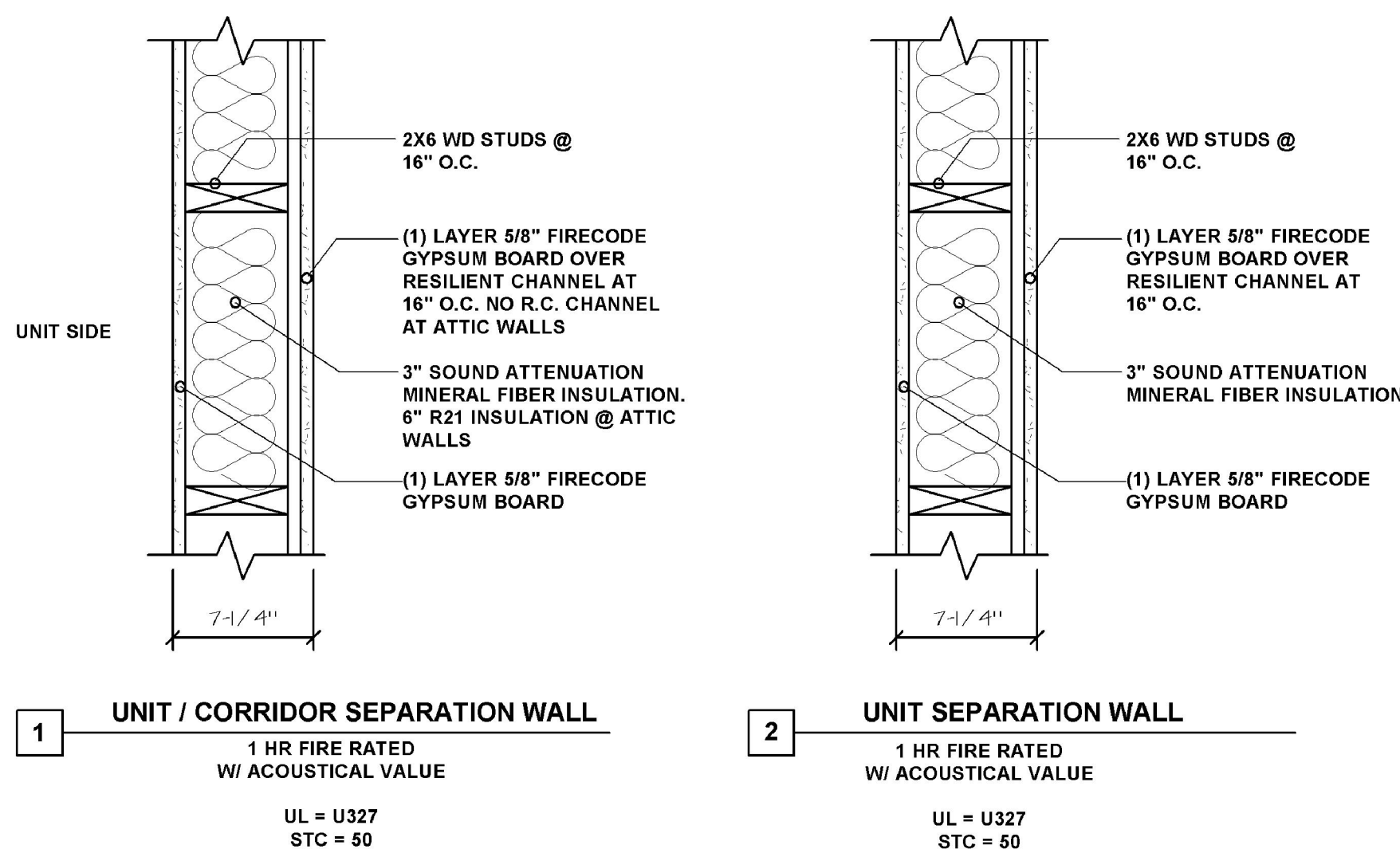

WALL TYPES

SCALE: NTS

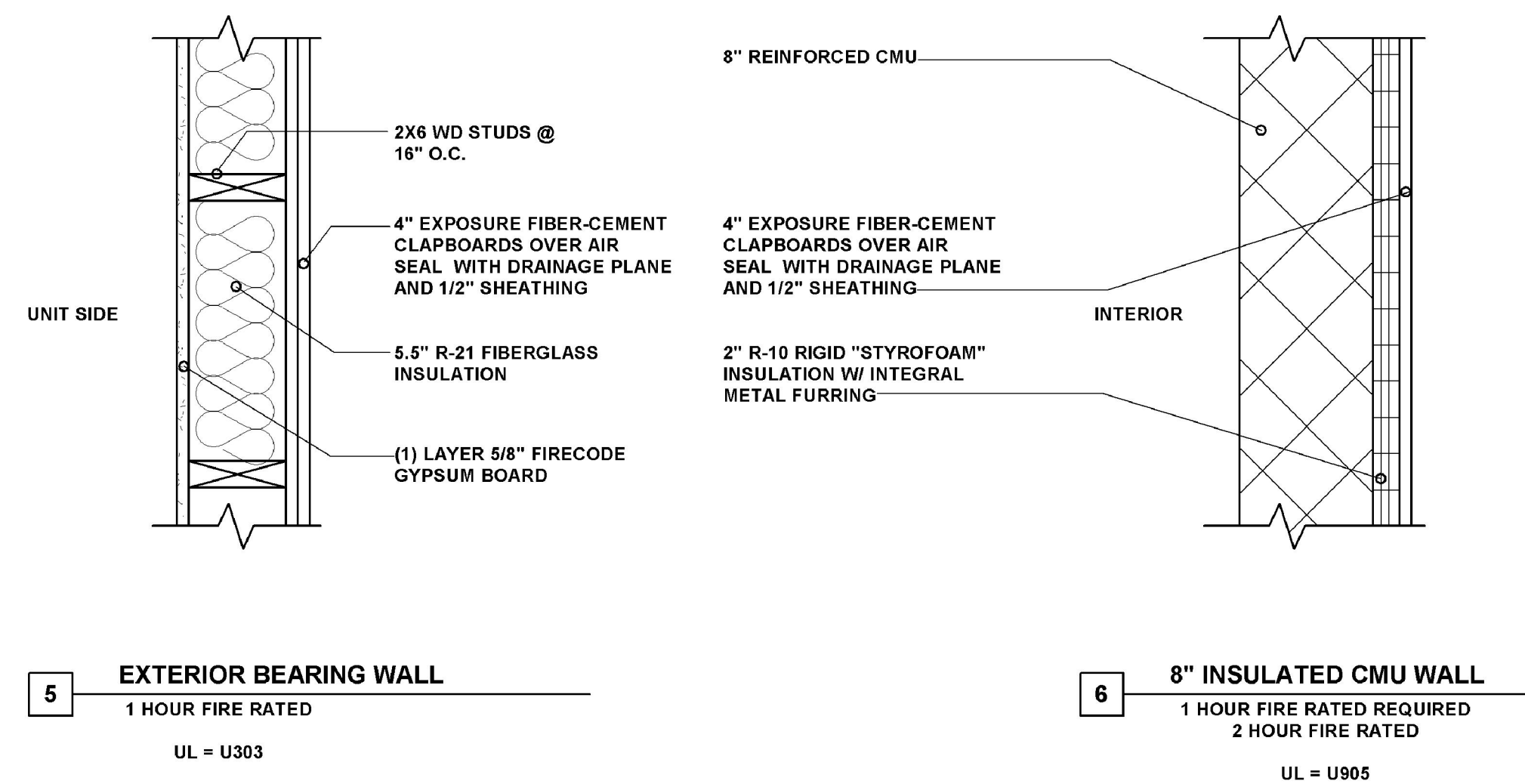

WALL & FLOOR TYPES

NOTES:
THE CONTRACTOR IS RESPONSIBLE FOR CONFIRMING ALL DIMENSIONS IN THE FIELD. THE CONTRACTOR SHALL IMMEDIATELY CONTACT THE ARCHITECT WITH ANY DISCREPANCIES FROM THE DRAWINGS. DO NOT SCALE THE DRAWINGS. THE ARCHITECT SHALL NOT BE RESPONSIBLE FOR CONSTRUCTION MEANS, METHODS OR SAFETY PRECAUTIONS.

For: 860-556-5525
E-Mail: PETER.SPRINGSTEEL@NETNET

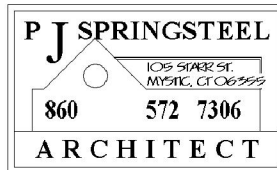

OWNERS:
1961 BOSTON POST ROAD LLC & VISTA VOCATIONAL LIFE SKILLS CENTER, INC

CIVIL ENGINEER
DOANE-COLLINS ENGINEERING ASSOCIATES, LLC
P.O. BOX 113
CENTERBROOK, CT 06409
T:(860)-767-0138

STRUCTURAL ENGINEER
The Winthrop Group
P.O. BOX 30
LEDYARD, CT 06339
T:(860)460-1606

ARCHITECT
PETER J SPRINGSTEEL ARCHITECT LLC
105 STARR STREET
MYSTIC, CT 06355
T:(860)572-7306

DATE:	07/07/15
REV 1:	SITE PLAN UPDATE 3-14-14
REV 2:	ARCH. UPDATE 4-9-14
REV 3:	ARCH. UPDATE 5-19-14
REV 4:	FOUNDATION C.D. 9-17-14
REV 5:	BUILDING PERMIT 6-30-15